



mitzvah

air curtain



How to choose Mitzvah Air Curtains

› Type

Recirculating | Non-Recirculating

› Flow

Top to Bottom | Sideways | Bottom to Top

› Mounting

Surface Mounted | Recessed

› Fan

Centrifugal | Cross flow | Axial

› Placement

Inside | Outside

Merits of installing an air curtain

› Maintain Hygiene

Prevents the surroundings and sustains hygiene by keeping away.

› Avail Maximum Comfort

Maintains stability in environment and increases staff and customer comfort.

› Become Energy Efficient

Reduces energy loss, building running costs and CO2 emissions

› Save Manpower

Retains comfortable working environment and reduces exhaustion.

› Attain Safety

Eliminates physical obstruction, reduces misting and facilitates evacuation.

› Exercise Profitability

Increases sales with 'Open door effect' by abolishing visual barriers for customers.



Common places where air curtains are installed

1 Retail & Hospitality



2 Automobiles



3 Manufacturing



4 Speciality Air Curtain



5 Cold Room & Freezer



6 Conveyors & Oven Doors



7 HVAC & Institutions



8 Food Processing Industry



9 Meat and Dairy Industry



What makes us exceptional?



Global Presence

Prevents the surroundings and sustains hygiene by keeping away.



Indigenous Manufacturing

Maintains stability in environment and increases staff and customer comfort.



Excellent Service

Reduces energy loss, building running costs and CO2 emissions.

Standards & Certifications





Model Number Configuration

ASP 2 090 A P

Series	#of Motors	Size	Voltage/RPM	MOC of blower
Various Series of Air Curtains	Number of Motors used in Machine	In Cms 090-210	A - 220V/1P/50HZ/2800RPM B - 220V/1P/60HZ/2800RPM C - 440V/3P/50HZ/1400RPM D - 110V/1P/50HZ/2800RPM E - 440V/3P/50HZ/2800RPM F - 220V/1P/50HZ/1400RPM G - 24VDC/1400RPM	A - Aluminium P - Plastic G - Galvanized Iron S - Stainless Steel

Technical & Dimensional Spec (ARP & ARS Series)

Flow Type Fan Type RPM	Non Recirculating Centrifugal					
	2800	2800	2800	2800	2800	2800
#of Motor @Wattage	1@120W	1@120W 1@80W	1@120W 1@80W	2@120W	2@120W 1@80W	3@120W
#of Blowers	2	3	3	4	5	6
Max Vel at Nozzle (ft/M/L) m/s	21/18/16	21/18/16	21/18/16	21/18/16	21/18/16	21/18/16
Remote	✓	✓	✓	✓	✓	✓
CMH	1000	1500	1500	2000	2500	3000
Sound Level (dB) A Scale	56	56	56	57	58	58
Dimensions (mm) (W x H x L)	208 235 605	208 235 800	208 235 1000	208 235 1195	208 235 1490	208 235 1785
Height (mm)	235	235	235	235	235	235
Weight	10Kgs	15Kgs	16Kgs	18Kgs	23Kgs	26Kgs
CBM per 100	5.4	7.8	8.4	10.2	12.4	15
Shipping Dimension	280 290 665	280 290 960	280 290 1060	280 290 1255	280 290 1550	280 290 1845
Pictorial Representation	Dwg 1001	Dwg 1001	Dwg 1001	Dwg 1001	Dwg 1001	Dwg 1001
Model	ARP 1060AP	ARP 2090AP	ARP 2100AP	ARP 2120AP	ARP 3150AP	ARP 3180AP

Technical & Dimensional Spec (ASP & ASS Series)



Flow Type	Non Recirculating						
Fan Type	Centrifugal						
RPM	2800	2800	2800	2800	2800	2800	2800
#of Motor @Wattage	1@120W	1@120W 1@80W	1@120W 1@80W	2@120W	2@120W 1@80W	3@120W	3@120W 1@80W
#ofBlowers	2	3	3	4	5	6	7
Max Vel at Nozzle (FPM/L) m/s	21/16	21/16	21/16	21/16	21/16	21/16	21/16
MOC Motor Shell	Aluminium	Aluminium	Aluminium	Aluminium	Aluminium	Aluminium	Aluminium
Motor Winding	Copper	Copper	Copper	Copper	Copper	Copper	Copper
CMH	1000	1500	1500	2000	2500	3000	3500
Dimensions (mm) (W x H x L)	308 335 605	308 335 900	308 335 1000	308 335 1195	308 335 1490	308 335 1785	308 335 2080
Sound Level (db) A Scale	56	56	56	57	58	58	59
Weight	10Kgs	15Kgs	16Kgs	18Kgs	23Kgs	26Kgs	28Kgs
CBM per 100	5.4	7.8	8.6	10.2	12.6	15.0	17.4
Shipping Dimension	280 290 665	280 290 960	280 290 1060	280 290 1255	280 290 1550	280 290 1845	280 290 2140
Pictorial Representation	Dwg 1001	Dwg 1001	Dwg 1001	Dwg 1001	Dwg 1001	Dwg 1001	Dwg 1001
Model	ASP 1060AP	ASP 2090AP	ASP 2100AP	ASP 2120AP	ASP 3150AP	ASP 3180AP	ASP 4210AP

Technical & Dimensional Spec (RSP, RSS & RSL Series)

Flow Type	Non Recirculating						
Fan Type	Centrifugal						
RPM	2800	2800	2800	2800	2800	2800	2800
#of Motor @Wattage	1@120W	1@120W 1@80W	1@120W 1@80W	2@120W	2@120W 1@80W	3@120W	3@120W 1@80W
#ofBlowers	2	3	3	4	5	6	7
Max Vel at Nozzle (FPM/L) m/s	21/16	21/16	21/16	21/16	21/16	21/16	21/16
MOC Motor Shell	Aluminium	Aluminium	Aluminium	Aluminium	Aluminium	Aluminium	Aluminium
Motor Winding	Copper	Copper	Copper	Copper	Copper	Copper	Copper
CMH	1000	1500	1500	2000	2500	3000	3500
Dimensions (mm) (W x H x L)	320 345 605	320 345 900	320 345 1000	320 345 1195	320 345 1490	320 345 1785	320 345 2080
Sound Level (db) A Scale	56	56	56	57	58	58	59
Weight	10Kgs	15Kgs	16Kgs	18Kgs	23Kgs	26Kgs	28Kgs
CBM per 100	5.4	7.8	8.6	10.2	12.6	15.0	17.4
Shipping Dimension	280 290 665	280 290 960	280 290 1060	280 290 1255	280 290 1550	280 290 1845	280 290 2140
Pictorial Representation	Dwg 1002	Dwg 1002	Dwg 1002	Dwg 1002	Dwg 1002	Dwg 1002	Dwg 1002
Model	RSP 1060AP	RSP 2090AP	RSP 2100AP	RSP 2120AP	RSP 3150AP	RSP 3180AP	RSP 4210AP



Exploded View for ARP, ARS, ASP, ASS Series

Deg 1001

Front View



Side View

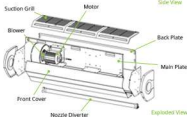

Exploded View

Installation



Exploded View for RSP, RSS, RSL Series

Deg 1002

Front View



Side View

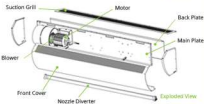

Exploded View





Product Characteristics

- ▶ Easy to open, convenient design.
- ▶ The Machine is available in Stainless Steel Option also as per GMP standards.
- ▶ The ingeniously designed casing is 40% lighter than normal machines suitable for installation over glass doors and marble.
- ▶ With a uniquely designed air guide bar, it can produce wind in all directions, working well in various environment.
- ▶ It can be operated by remote control or at the touch of a button.
- ▶ It has high, medium, and low speed switch functions.
- ▶ Adopting optimized electrical machinery; reliably, and safe for 24x7 hours
- ▶ Vast Range of Sizes:-

600mm	900mm	1000mm	1200mm
1500mm	1800mm	2000mm	2100mm

Advance electrical machinery is design to run continuously with low noise level

Can be activated with opening of the Door, with a LIMIT SWITCH

The irregular distancing and ultra-quiet wind wheel can produce a powerful air-flow



mitzvah
air curtains

Our Clients

Allana

amazon.com



Cadbury



LODHI



ITC Limited



Apollo
HOSPITALS
POWERED BY
DR. RAJESH KUMAR

Fortis



Google

Mitzvah Engg. Inc.

› Corporate:

D 60, Sector 2, Noida
Uttar Pradesh
India 201301

› www.mitzvah.in

› Manufacturing:

A-7/119, SSGT Road
Industrial Area
Ghaziabad, Uttar Pradesh
India - 201009

› enquiry@mitzvah.in



+91 92110 92110